

Department of Engineering
Tim Bryan, P.E., County Engineer

3137 South Liberty Street, Canton, MS 39046
Office (601) 790-2525 FAX (601) 859-3430

MEMORANDUM

June 21, 2023

To: Sheila Jones, Supervisor, District I
Trey Baxter, Supervisor, District II
Gerald Steen, Supervisor, District III
Karl Banks, Supervisor, District IV
Paul Griffin, Supervisor, District V

From: Tim Bryan, P.E., PTOE
County Engineer

Re: Comcast Cable Utility Permit
County Road Name, Stump Bridge Road

The Engineering Department recommends approval of the permit application for Comcast Cable is attaching 24 CT fiber to existing poles, boring and installing 2" HDPE to pull 48 CT and 24 CT fiber within the right-of-way owned by the County including the listed roads below.

- Stump Bridge Road

Revised: 2/14/2019



PERMIT APPLICATION FOR THE CONSTRUCTION OR ADJUSTMENT OF A UTILITY WITHIN COUNTY ROAD RIGHT-OF-WAY

Utility Information: Utility Name: COMCAST CABLE

Address: 3425 Malone Drive City/State/Zip: Chamblee/ GA/ 30-341

Contact Person: Linda Taibl Contact's Phone: _____

Project Information: County Road Name: Stump Bridge Rd

(If located within more than one road right-of-way, use Appendix 1 for additional descriptions)

Beginning Location: 32.68463, -89.97134 Ending Location: 32.69953, -89.95444

Length of Project: 8067FT Section: 34 Township: 3 Range: 69

Description of Work: COMCAST IS ATTACHING 24CT FIBER TO EXISTING POLES, BORING AND INSTALLING 2" HDPE TO PULL 48CT AND 24CT FIBER WITHIN THE RIGHT-OF-WAY OWNED BY THE COUNTY.

TOTAL INSTALLATION LENGTH IN ROW: 8067FT

Check Box if Appendix 1 is to be included as a part of this Application

Whereas the above stated Utility makes application to the **Madison County Board of Supervisors** for a Construction Permit. Attached hereto are drawings and plans for the construction of the above facilities located within Madison County owned public rights-of-way. Once stamped by the Madison County Engineering Department, these plans shall not be changed or altered without written approval of the County Engineer, or his representative. A copy of the approved permit and plans shall be on-site at all times during construction.

The Applicant Utility shall comply with all policies, procedures and construction practices as outlined in *A Policy for The Accommodation of Utility Facilities within the Right-of-Way of all Public County Roads* (hereinafter referred to as the "Policy"), as adopted on November 1, 2005, by the **Madison County Board of Supervisors**, and which is hereby made a part of this Application Agreement.

If facilities are to be located within the Rights-of-Way of the County-Federal or State Aid System, Applicant Utility also agrees to comply with applicable provisions of *S.O.P. No. SA II-2-8, Accommodation of Utilities on Rights-of-Way*, issued by the State Aid Engineer and dated July 1, 2005.

The Applicant Utility understands and agrees that, except as herein granted, no right, title, claim, or easement to said road right-of-way is granted by the issuance of this permit. If this Utility is listed in the general provisions of the Policy, it will be adjusted to comply with same without cost to the County, unless the variance from the Policy has been approved by the granting of the Permit pursuant to this Application.

The Applicant Utility further understands that the Utility's engineering, plant, or other personnel will be responsible for the staking and construction supervision of the work set out above and as shown on the attached plans. If work impacts traffic in any way, the appropriate traffic control shall be installed per the *Manual of Uniform Traffic Control Devices*, Latest Edition.

The Applicant Utility understands that the County Engineer, or his representative, may issue a Stop Work Order at any time if it is deemed that site conditions are not suitable for construction or if any of the requirements of this permit are not being met.

Many County Roads have variable Rights-of-Way and/or no Right-of-Way at all and are maintained under a Prescriptive Easement. It is the sole responsibility of the Applicant Utility to verify the existence and limits of public rights-of-way. If none exists, it is the

responsibility of the Applicant Utility to acquire an easement for their Facilities from the applicable property owner(s). Madison County in no way verifies the limits of Right-of-Way as shown on the permit application.

The Applicant Utility shall be responsible for all future maintenance and repair of the facilities installed under this permit. The Applicant Utility shall make future adjustments to, or relocate, the facilities located within road or highway right-of-way when required for road or highway widening or other road or highway construction at no cost to Madison County. The Applicant Utility shall relocate said utilities within sixty (60) days of notification by County by registered mail, return receipt requested, unless otherwise designated by the County Engineer. Further, any maintenance, repair, or construction shall be done in such a manner as to occasion no unreasonable interference with the normal flow and safety to traffic and at the expense of the utility company. When reasonable care has been taken to locate said utility facilities within the right-of-way, the Applicant Utility understands that any damages caused by routine maintenance and construction by County forces shall be borne by the Applicant Utility.

The Applicant Utility further agrees to indemnify and hold Madison County harmless for any and all claims, accidents, damages, liabilities and expenses occasioned wholly, or in part, by any act or omission of applicant, its agents or employees. In case County shall, without fault on its own part, be made a party to any litigation commenced by or against applicant, then applicant shall protect and hold County harmless, and shall pay all costs, expenses and reasonable attorney's fees incurred or paid by County in connection with said litigation.

All underground facilities shall be installed at a depth equal to or greater than 48" below the lowest adjacent grade.

All pipes carrying liquid shall be encased under County maintained roads.

WITNESS the signature of the Applicant this the 19 day of 06, 2023.

By: Linda Taibl
(Applicant Signature)

Title: Construction specialist

Note: Applicant must be an employee of the Utility named in this application. The Madison County Board of Supervisors will not recognize a Contractor, Subcontractor, Agent, or Consulting Engineer as the Applicant. Utility Company shall be fully responsible for all work performed under this application.

I, or my authorized representative, have reviewed this application and determined that the drawing, sketches, and plans submitted by the Applicant meet the requirements of *A Policy for The Accommodation of Utility Facilities within the Right-of-Way of all Public County Roads.*

APPROVED

By: **By timothy.bryan at 12:42 pm, Jun 27, 2023**

Tim Bryan, P.E. **BJ**
County Engineer

AGREED TO AND APPROVED BY:

Madison County Board President

Date: _____

ENTERED INTO THE MINUTES OF THE BOARD OF SUPERVISORS OF MADISON COUNTY, MISSISSIPPI ON THIS

____ DAY OF _____, 20____.

Appendix 1

County Road Name: Stump Bridge Rd
Beginning Location: 32.68463, -89.97134 Ending Location: 32.69953, -89.95444
Length of Project: 8067FT Section: 34 Township: 3 Range: 69
Description of Work: ATTACH NEW 24CT FIBER TO EXISTING POLES, BORE AND INSTALL
2" HDPE TO PULL NEW 24CT AND 48CT FIBER WITHIN THE STUMP BRIDGE RD RIGHT-OF WAY.

County Road Name: _____
Beginning Location: _____ Ending Location: _____
Length of Project: _____ Section: _____ Township: _____ Range: _____
Description of Work: _____

County Road Name: _____
Beginning Location: _____ Ending Location: _____
Length of Project: _____ Section: _____ Township: _____ Range: _____
Description of Work: _____

County Road Name: _____
Beginning Location: _____ Ending Location: _____
Length of Project: _____ Section: _____ Township: _____ Range: _____
Description of Work: _____

County Road Name: _____
Beginning Location: _____ Ending Location: _____
Length of Project: _____ Section: _____ Township: _____ Range: _____
Description of Work: _____

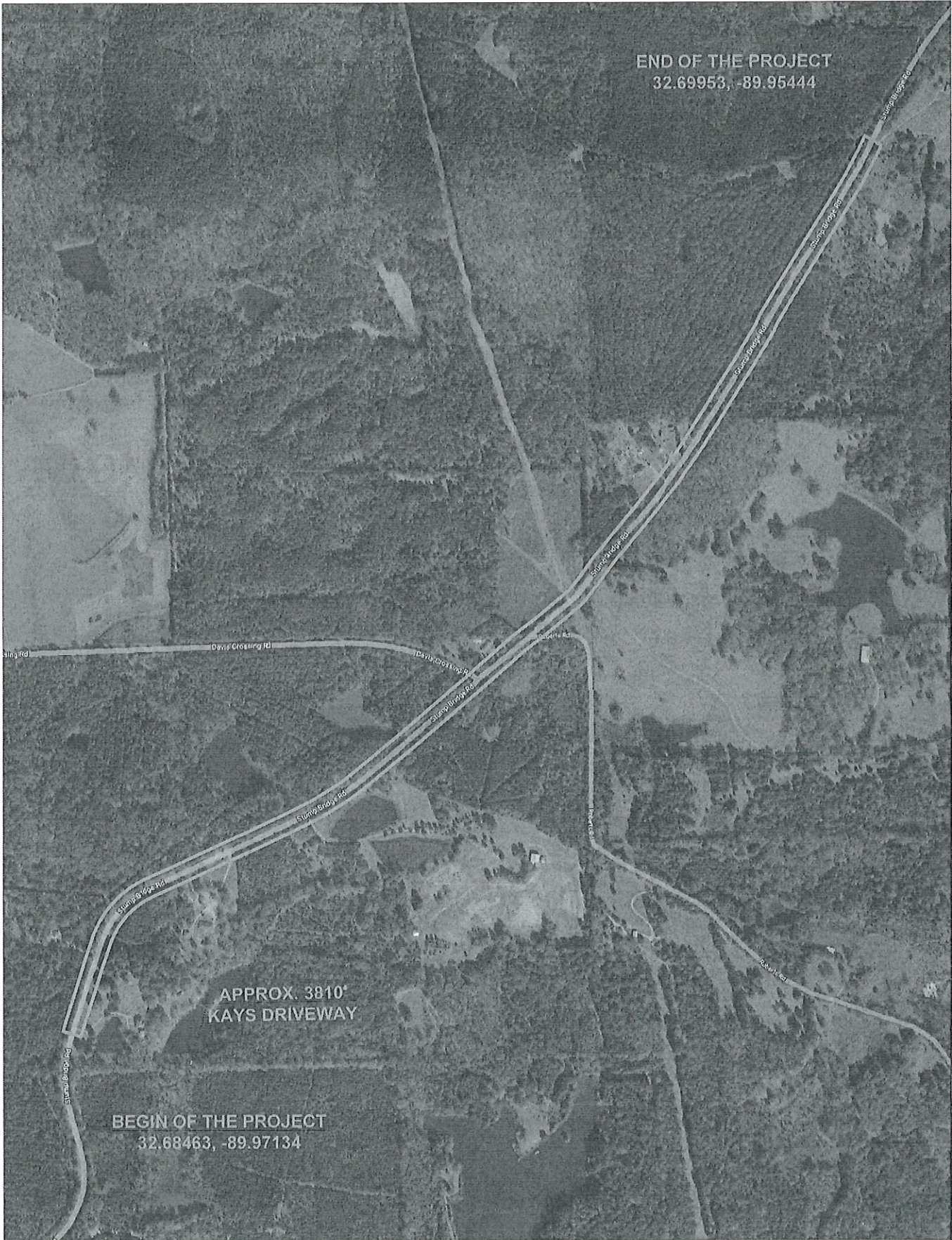

END OF THE PROJECT
32.69953, -89.95444

APPROX. 3810'
KAYS DRIVEWAY

BEGIN OF THE PROJECT
32.68463, -89.97134

<p>PREPARED BY:</p>	<p>COMCAST IS ATTACHING FIBER TO EXISTING POLES, BORING AND INSTALLING NEW CONDUIT WITHIN THE RIGHT-OF-WAY OWNED BY THE COUNTY. TOTAL: 8067 ft</p>		<p>ENGINEERED FOR:</p>
<p>QUASAR, INC.</p>	<p>NO SCALE</p>		<p>COMCAST</p>

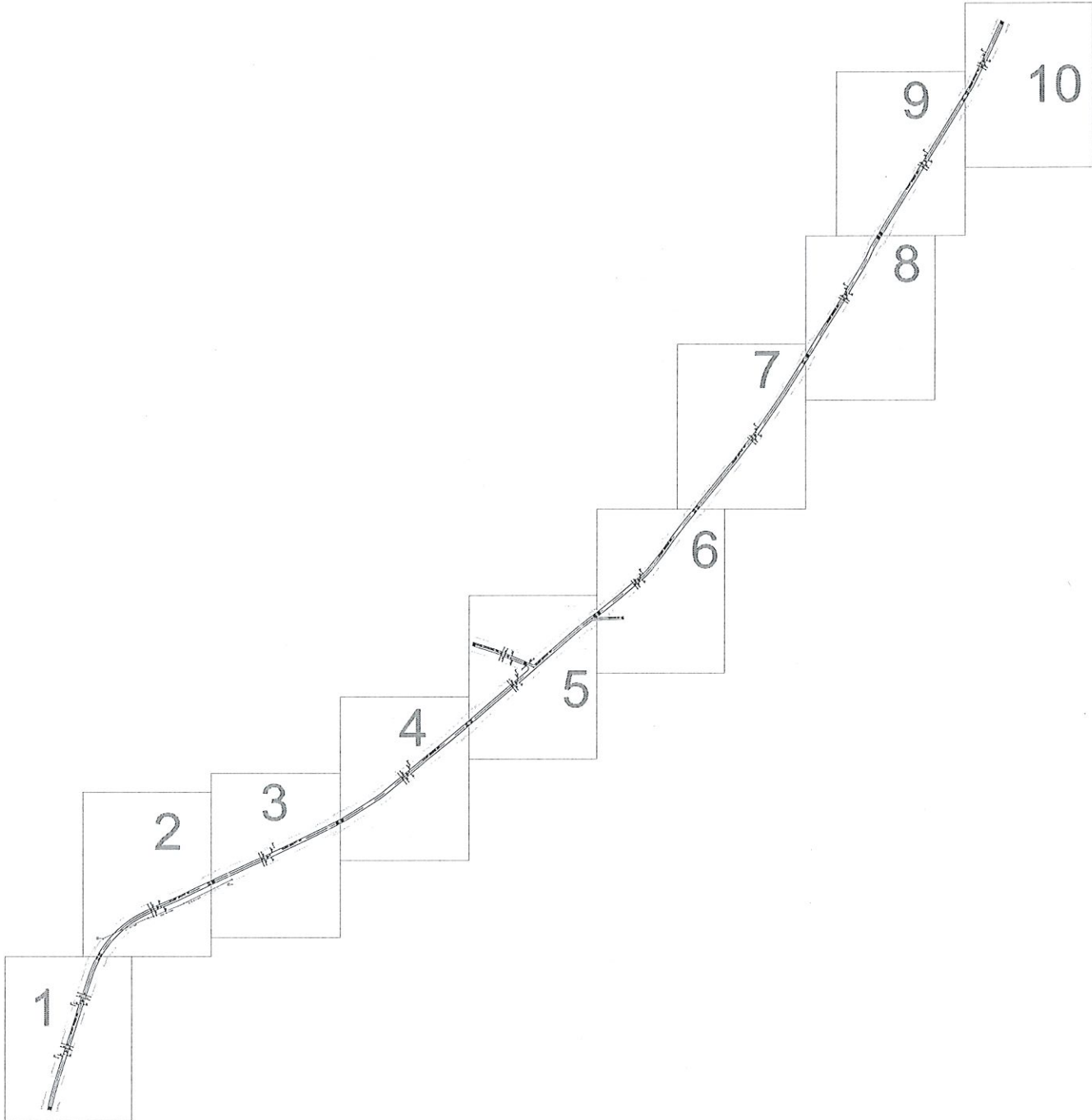

PREPARED BY:

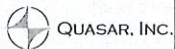

QUASAR, INC.

COMCAST IS ATTACHING FIBER TO EXISTING
 POLES, BORING AND INSTALLING NEW CONDUIT WITHIN
 THE RIGHT-OF-WAY OWNED BY THE COUNTY.
 TOTAL: 8067 ft

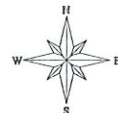

ENGINEERED FOR:



NO SCALE

PROPOSED COMCAST UNDERGROUND
DIRECTIONAL BORE
4' MINIMUM DEPTH AT ALL POINTS
1 24CT FIBER CABLE
NO OTHER BURIED UTILITIES EXIST

INSTALLATION LENGTH IN RW ON THIS SHEET 822 FT

NO MATCH SHEET

NO MATCH SHEET

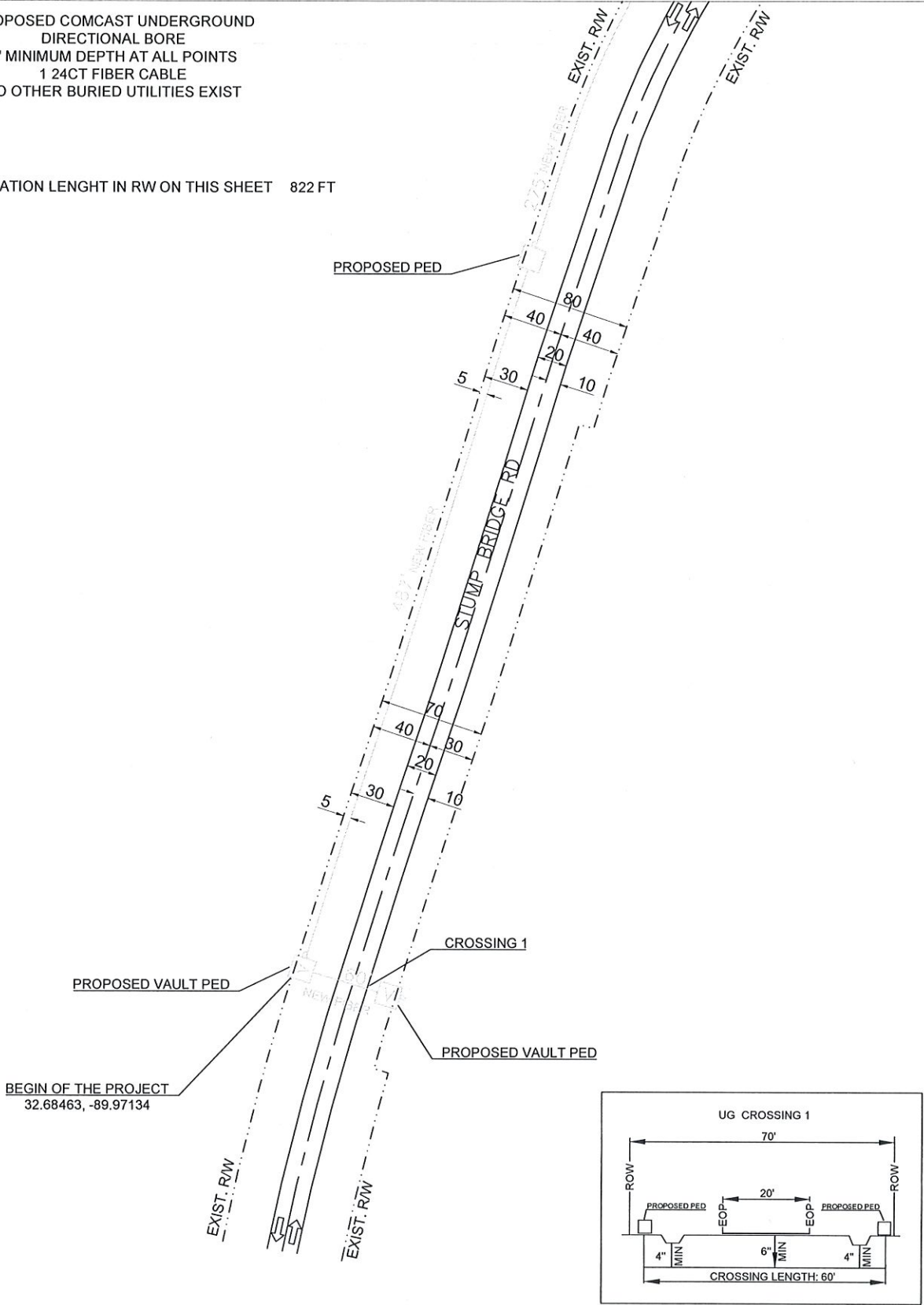

NO MATCH SHEET

PREPARED BY: 	EXISTING POLE PROPOSED PEDESTAL PROPOSED VAULT WATER VALVE FIBER MARKER GAS MARKER MANHOLE SEWER MANHOLE STORM DRAIN	RIGHT OF WAY LINE IRRIGATION LINE WATER LANE GAS LANE PROPOSED ANCHOR PROPOSED RISER	PROPOSED COAXIAL CABLE PROPOSED FIBER CABLE PROPOSED DIRECTIONAL BORE EXISTING CABLE		ENGINEERED FOR: 	MADISON COUNTY STUMP BRIDGE RD TRANSPORT FIBER
	LEGEND: RW - RIGHT OF WAY EOP - EDGE OF PAVEMENT DW - DRIVEWAY PDW - PAVED DRIVEWAY	NOTES: BORE HOLE TO BE FILLED SAME DAY VAULT HOLE TO BE FILLED SAME DAY ALL HOLE TO BE TAMPED AND SOODED	NO SCALE SHEET 1 OF 10			

NO MATCH SHEET

PROPOSED COMCAST NEW ATTACHMENT
 18' MINIMUM HEIGHT AT ALL POINTS
 1 24CT FIBER CABLE

INSTALLATION LENGTH IN RW ON THIS SHEET 763 FT

NO MATCH SHEET

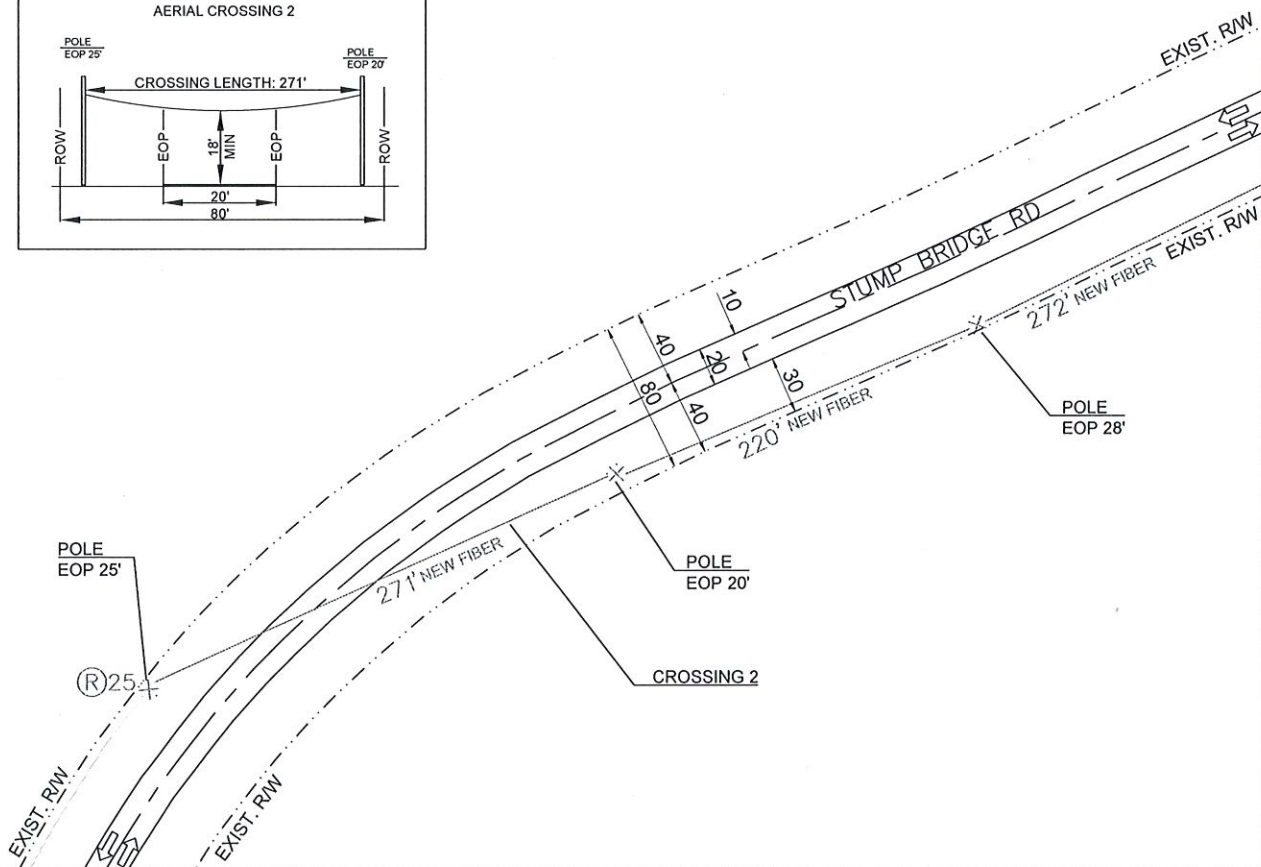
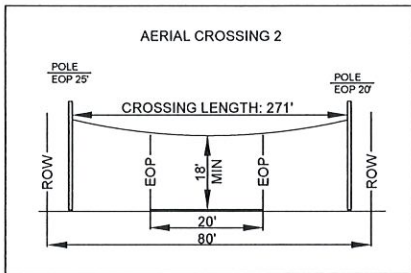

MATCH SHEET 3

MATCH SHEET 1

PREPARED BY: 	EXISTING POLE PROPOSED PEDESTAL PROPOSED VAULT WATER VALVE FIBER MARKER GAS MARKER MANHOLE SEWER MANHOLE STORM DRAIN	RIGHT OF WAY LINE IRRIGATION LINE WATER LANE GAS LANE PROPOSED ANCHOR PROPOSED RISER LEGEND: RW - RIGHT OF WAY EOP - EDGE OF PAVEMENT DW - DRIVEWAY PDW - PAVED DRIVEWAY	PROPOSED COAXIAL CABLE PROPOSED FIBER CABLE PROPOSED DIRECTIONAL BORE EXISTING CABLE		ENGINEERED FOR: 	MADISON COUNTY STUMP BRIDGE RD TRANSPORT FIBER
	NOTES: BORE HOLE TO BE FILLED SAME DAY VAULT HOLE TO BE FILLED SAME DAY ALL HOLE TO BE TAMPED AND SODDED	NO SCALE SHEET 2 OF 10				

NO MATCH SHEET

PROPOSED COMCAST UNDERGROUND
DIRECTIONAL BORE
4' MINIMUM DEPTH AT ALL POINTS
1 24CT FIBER CABLE
NO OTHER BURIED UTILITIES EXIST

INSTALLATION LENGTH IN RW ON THIS SHEET 708 FT

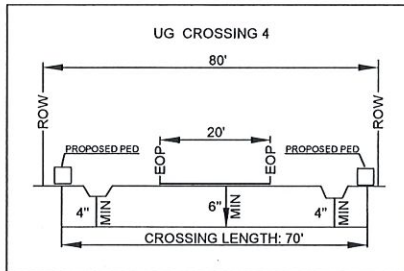
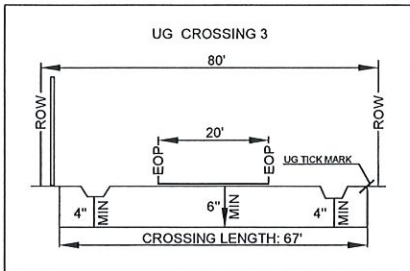
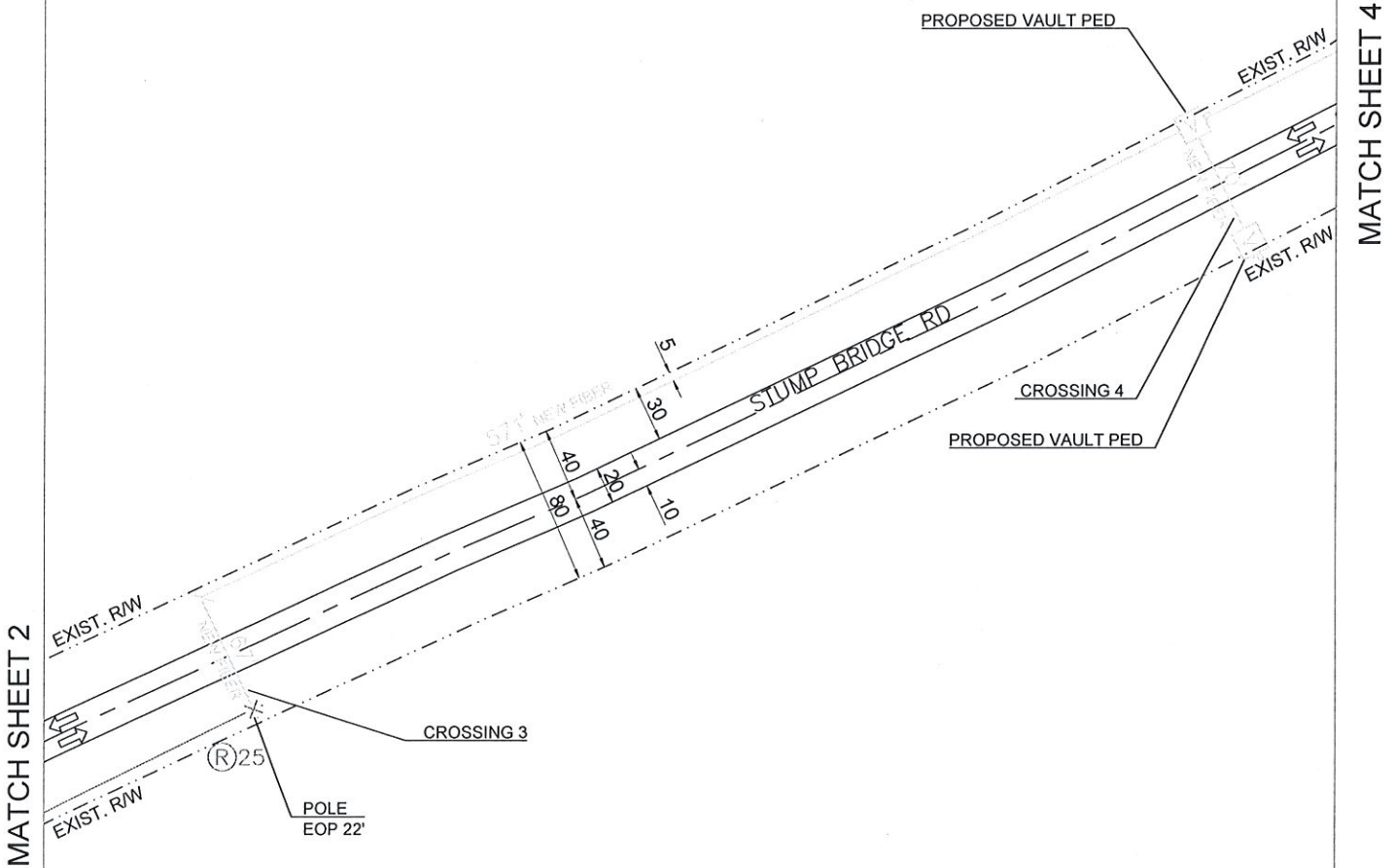

NO MATCH SHEET

<p>PREPARED BY:</p> <p>QUASAR, INC.</p>	<p>EXISTING POLE</p> <p>PROPOSED PEDESTAL</p> <p>PROPOSED VAULT</p> <p>WATER VALVE</p> <p>FIBER MARKER</p> <p>GAS MARKER</p> <p>MANHOLE</p> <p>SEWER MANHOLE</p> <p>STORM DRAIN</p>	<p>RIGHT OF WAY LINE</p> <p>IRRIGATION LINE</p> <p>WATER LANE</p> <p>GAS LANE</p> <p>PROPOSED ANCHOR</p> <p>PROPOSED RISER</p>	<p>PROPOSED COAXIAL CABLE</p> <p>PROPOSED FIBER CABLE</p> <p>PROPOSED DIRECTIONAL BORE</p> <p>EXISTING CABLE</p>		<p>ENGINEERED FOR:</p> <p>MADISON COUNTY</p> <p>STUMP BRIDGE RD</p> <p>TRANSPORT FIBER</p>
	<p>LEGEND:</p> <p>RW - RIGHT OF WAY</p> <p>EOP - EDGE OF PAVEMENT</p> <p>DW - DRIVEWAY</p> <p>POW - PAVED DRIVEWAY</p>	<p>NOTES:</p> <p>BORE HOLE TO BE FILLED SAME DAY</p> <p>VAULT HOLE TO BE FILLED SAME DAY</p> <p>ALL HOLE TO BE TAMPED AND SOODED</p>			<p>NO SCALE</p> <p>SHEET 3 OF 10</p>

NO MATCH SHEET

PROPOSED COMCAST UNDERGROUND
 DIRECTIONAL BORE
 4' MINIMUM DEPTH AT ALL POINTS
 1 24CT FIBER CABLE
 NO OTHER BURIED UTILITIES EXIST

INSTALLATION LENGTH IN RW ON THIS SHEET 1000 FT

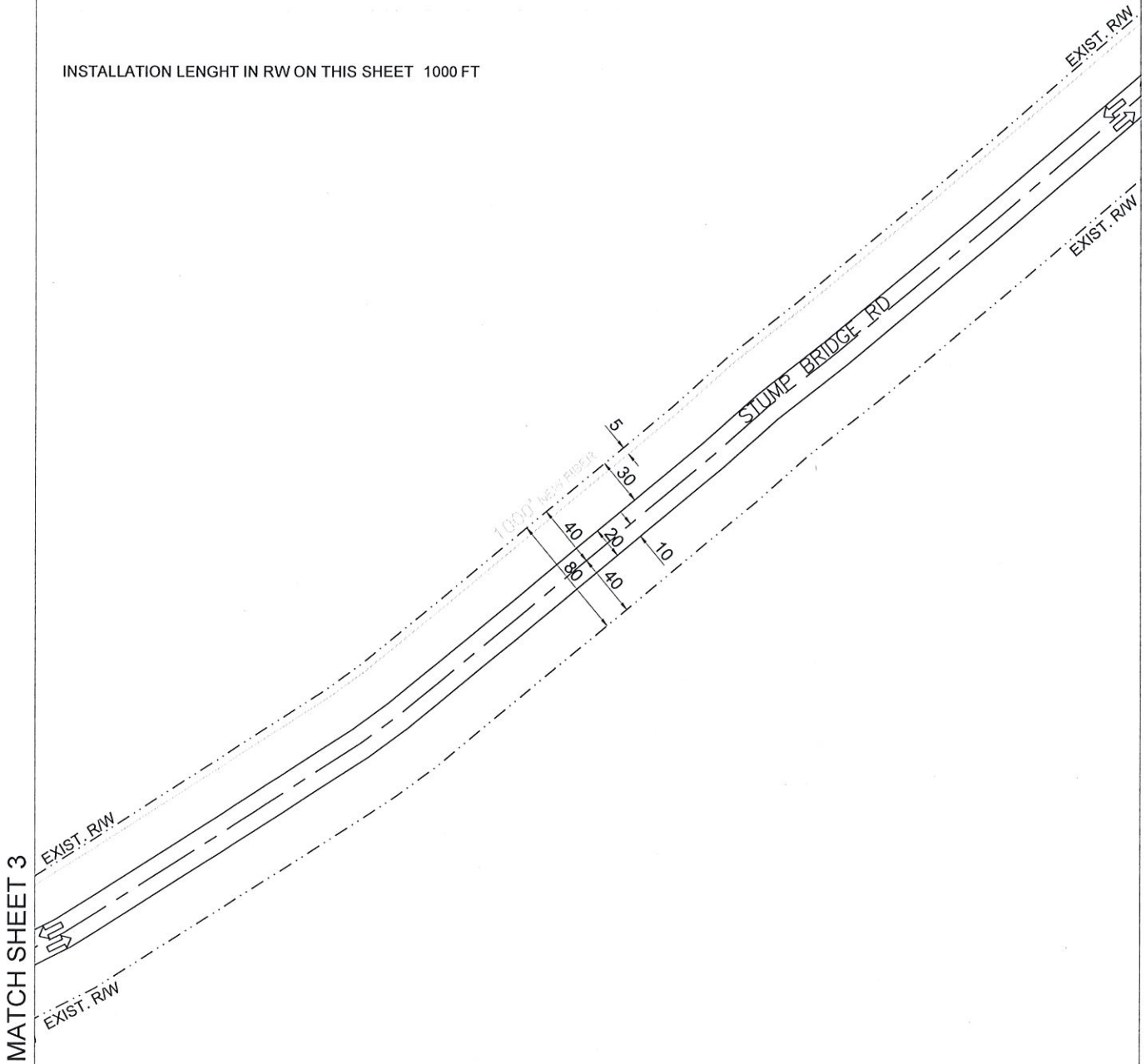

MATCH SHEET 5

MATCH SHEET 3

NO MATCH SHEET

PREPARED BY: 	EXISTING POLE PROPOSED PEDESTAL PROPOSED VAULT WATER VALVE FIBER MARKER GAS MARKER MANHOLE SEWER MANHOLE STORM DRAIN	RIGHT OF WAY LINE IRRIGATION LINE WATER LANE GAS LANE PROPOSED ANCHOR PROPOSED RISER	PROPOSED COAXIAL CABLE PROPOSED FIBER CABLE PROPOSED DIRECTIONAL BORE EXISTING CABLE		ENGINEERED FOR: 	MADISON COUNTY STUMP BRIDGE RD TRANSPORT FIBER
	LEGEND: RW - RIGHT OF WAY EOP - EDGE OF PAVEMENT DW - DRIVEWAY PDW - PAVED DRIVEWAY	NOTES: BORE HOLE TO BE FILLED SAME DAY VAULT HOLE TO BE FILLED SAME DAY ALL HOLE TO BE TAMPED AND SOCCED	NO SCALE		SHEET 4 OF 10	

NO MATCH SHEET

PROPOSED COMCAST UNDERGROUND
 DIRECTIONAL BORE
 4' MINIMUM DEPTH AT ALL POINTS
 1 48CT FIBER CABLE
 1 24CT FIBER CABLE
 NO OTHER BURIED UTILITIES EXIST

INSTALLATION LENGTH IN RW ON THIS SHEET 837 FT

MATCH SHEET 4

MATCH SHEET 6

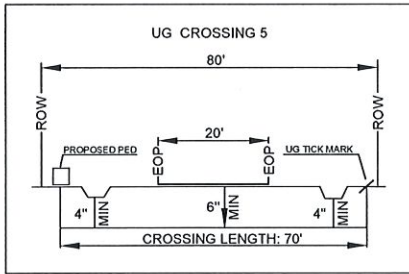
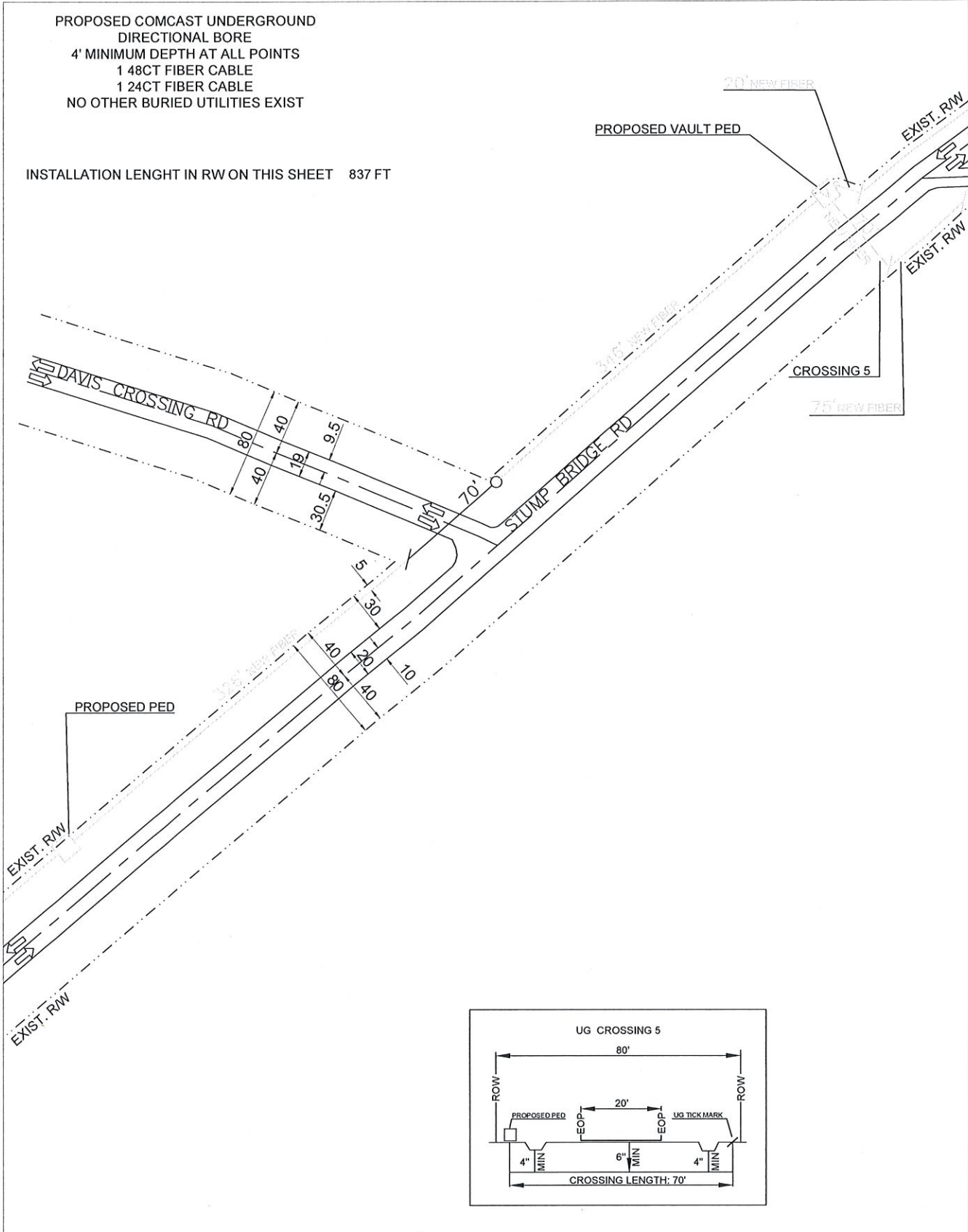

NO MATCH SHEET

PREPARED BY: 	EXISTING POLE PROPOSED PEDESTAL PROPOSED VAULT WATER VALVE FIBER MARKER GAS MARKER MANHOLE SEWER MANHOLE STORM DRAIN	RIGHT OF WAY LINE IRRIGATION LINE WATER LANE GAS LANE PROPOSED ANCHOR PROPOSED RISER	PROPOSED COAXIAL CABLE PROPOSED FIBER CABLE PROPOSED DIRECTIONAL BORE EXISTING CABLE		ENGINEERED FOR: 	MADISON COUNTY STUMP BRIDGE RD TRANSPORT FIBER
	LEGEND: RW - RIGHT OF WAY EOP - EDGE OF PAVEMENT DW - DRIVEWAY PDW - PAVED DRIVEWAY	NOTES: BORE HOLE TO BE FILLED SAME DAY VAULT HOLE TO BE FILLED SAME DAY ALL HOLE TO BE TAMPED AND SODDED	NO SCALE SHEET 5 OF 10			

PROPOSED COMCAST UNDERGROUND
 DIRECTIONAL BORE
 4' MINIMUM DEPTH AT ALL POINTS
 1 24CT FIBER CABLE
 NO OTHER BURIED UTILITIES EXIST

INSTALLATION LENGTH IN RW ON THIS SHEET 921 FT

MATCH SHEET 5

NO MATCH SHEET

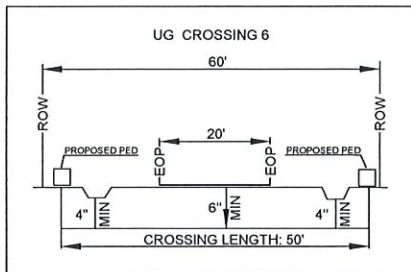
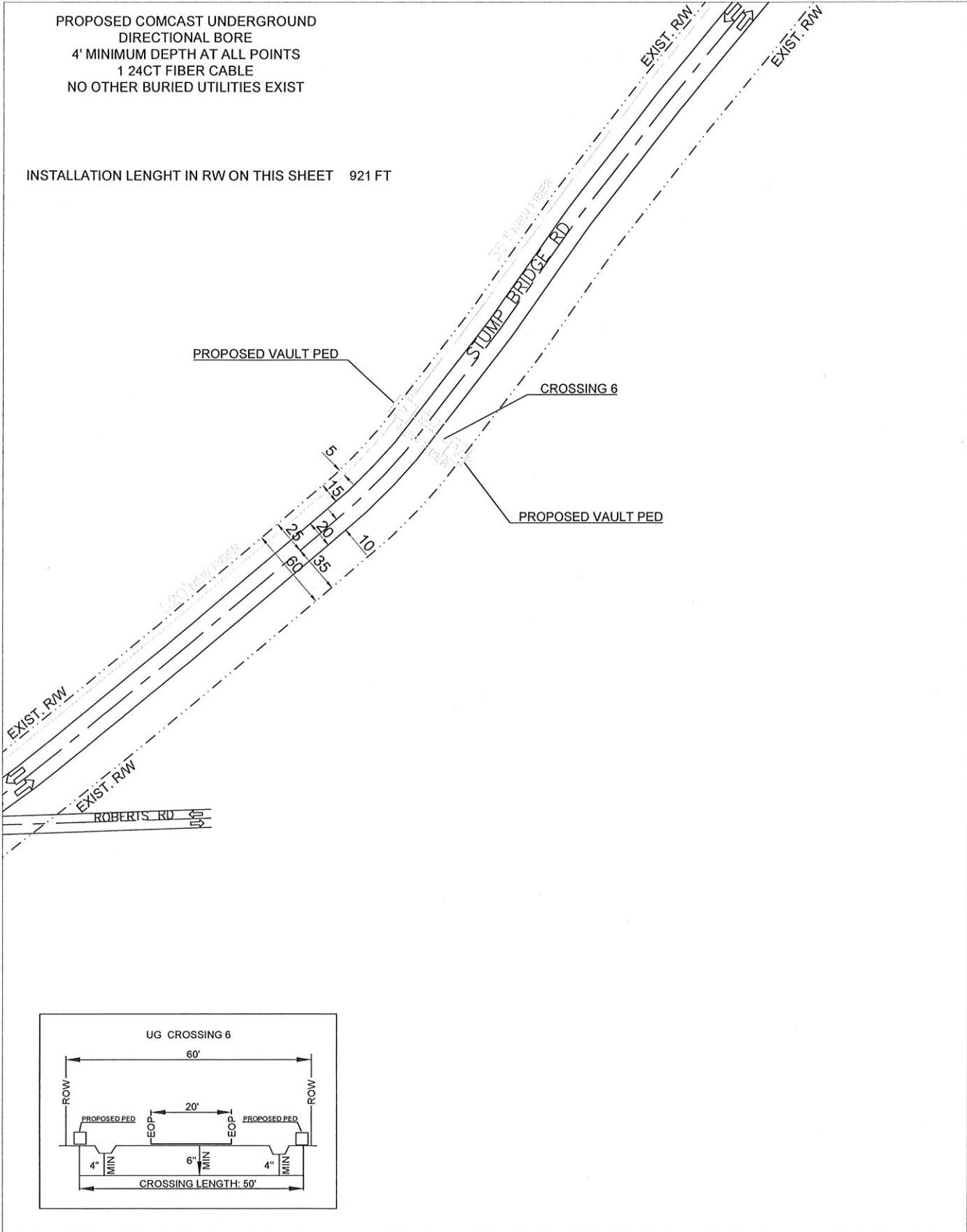

NO MATCH SHEET

PREPARED BY: 	EXISTING POLE PROPOSED PEDESTAL PROPOSED VAULT WATER VALVE FIBER MARKER GAS MARKER MANHOLE SEWER MANHOLE STORM DRAIN	RIGHT OF WAY LINE IRRIGATION LINE WATER LANE GAS LANE PROPOSED ANCHOR PROPOSED RISER	PROPOSED COAXIAL CABLE PROPOSED FIBER CABLE PROPOSED DIRECTIONAL BORE EXISTING CABLE		ENGINEERED FOR: 	MADISON COUNTY STUMP BRIDGE RD TRANSPORT FIBER
	LEGEND: RW - RIGHT OF WAY EOP - EDGE OF PAVEMENT DW - DRIVEWAY PDW - PAVED DRIVEWAY	NOTES: BORE HOLE TO BE FILLED SAME DAY VAULT HOLE TO BE FILLED SAME DAY ALL HOLE TO BE TAMPED AND SODDED	NO SCALE SHEET 6 OF 10			

NO MATCH SHEET

PROPOSED COMCAST UNDERGROUND
DIRECTIONAL BORE
4' MINIMUM DEPTH AT ALL POINTS
1 24CT FIBER CABLE
NO OTHER BURIED UTILITIES EXIST

INSTALLATION LENGTH IN RW ON THIS SHEET 996 FT

NO MATCH SHEET

MATCH SHEET 8

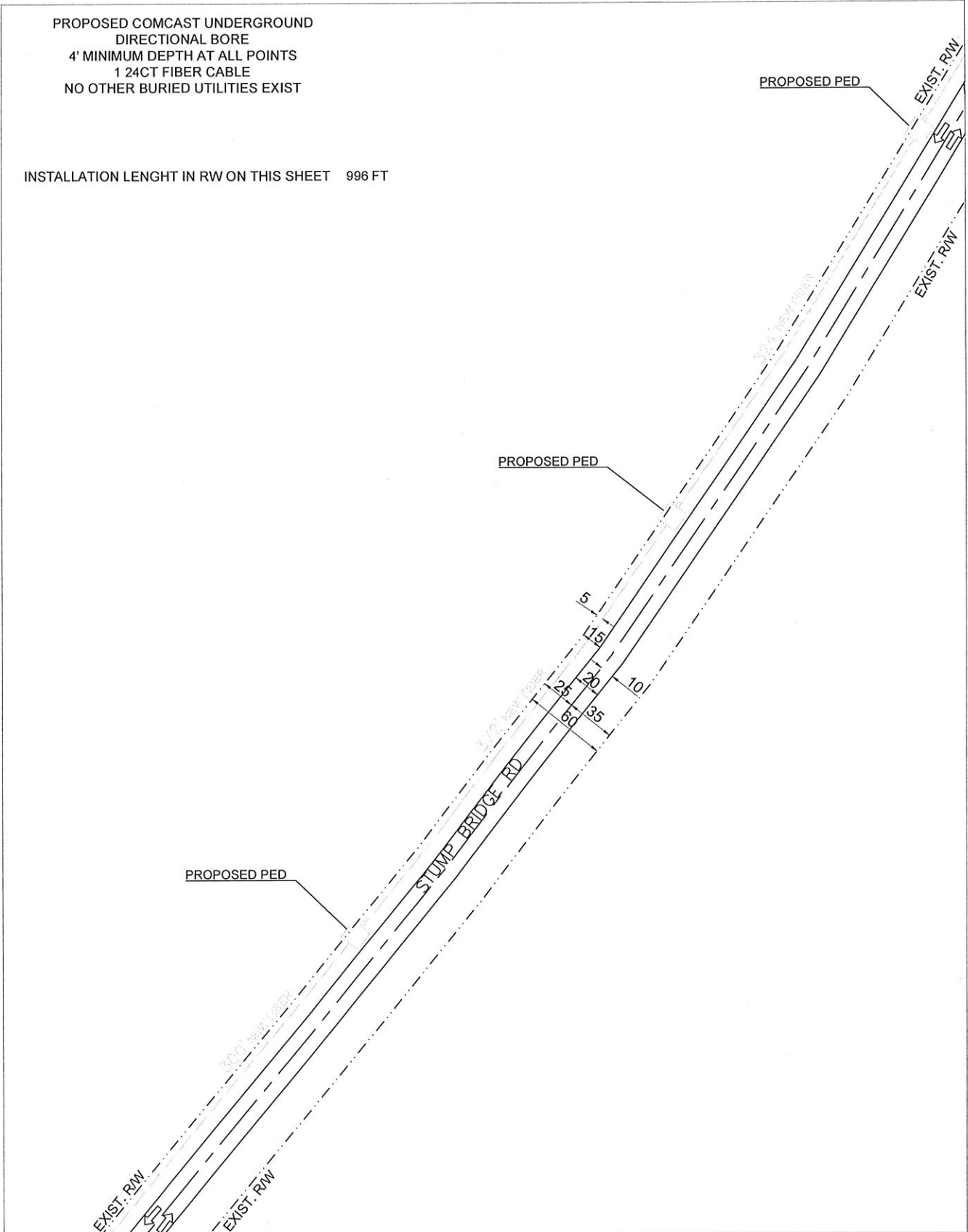

MATCH SHEET 6

<p>PREPARED BY:</p> <p>QUASAR, INC.</p>	<p>EXISTING POLE</p> <p>PROPOSED PEDESTAL</p> <p>PROPOSED VAULT</p> <p>WATER VALVE</p> <p>FIBER MARKER</p> <p>GAS MARKER</p> <p>MANHOLE</p> <p>SEWER MAINHOLE</p> <p>STORM DRAIN</p>	<p>RIGHT OF WAY LINE</p> <p>IRRIGATION LINE</p> <p>WATER LANE</p> <p>GAS LANE</p> <p>PROPOSED ANCHOR</p> <p>PROPOSED RISER</p>	<p>PROPOSED COAXIAL CABLE</p> <p>PROPOSED FIBER CABLE</p> <p>PROPOSED DIRECTIONAL BORE</p> <p>EXISTING CABLE</p>		<p>ENGINEERED FOR:</p> <p>MADISON COUNTY</p> <p>STUMP BRIDGE RD</p> <p>TRANSPORT FIBER</p>
	<p>LEGEND:</p> <p>RW - RIGHT OF WAY</p> <p>EOP - EDGE OF PAVEMENT</p> <p>DW - DRIVEWAY</p> <p>PDW - PAVED DRIVEWAY</p>	<p>NOTES:</p> <p>BORE HOLE TO BE FILLED SAME DAY</p> <p>VAULT HOLE TO BE FILLED SAME DAY</p> <p>ALL HOLE TO BE TAMPED AND SODDED</p>			<p>NO SCALE</p> <p>SHEET 7 OF 10</p>

MATCH SHEET 9

PROPOSED COMCAST UNDERGROUND
DIRECTIONAL BORE
4' MINIMUM DEPTH AT ALL POINTS
1 24CT FIBER CABLE
NO OTHER BURIED UTILITIES EXIST

INSTALLATION LENGTH IN RW ON THIS SHEET 785 FT

MATCH SHEET 7

NO MATCH SHEET

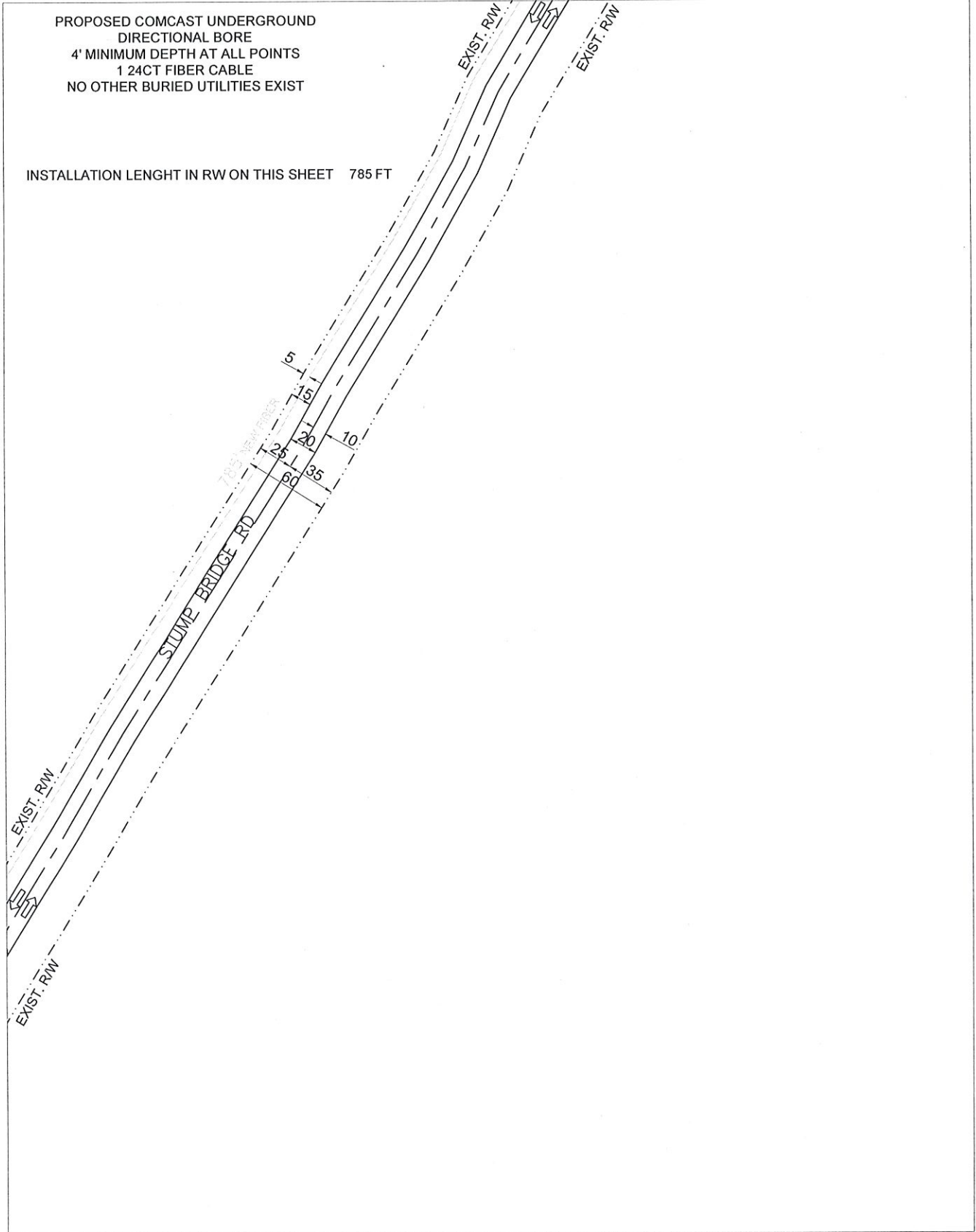

NO MATCH SHEET

PREPARED BY: 	EXISTING POLE PROPOSED PEDESTAL PROPOSED VAULT WATER VALVE FIBER MARKER GAS MARKER MANHOLE SEWER MANHOLE STORM DRAIN	RIGHT OF WAY LINE IRRIGATION LINE WATER LANE GAS LANE PROPOSED ANCHOR PROPOSED RISER LEGEND: RW - RIGHT OF WAY EOP - EDGE OF PAVEMENT DW - DRIVEWAY PDW - PAVED DRIVEWAY	PROPOSED COAXIAL CABLE PROPOSED FIBER CABLE PROPOSED DIRECTIONAL BORE EXISTING CABLE		ENGINEERED FOR: 	MADISON COUNTY STUMP BRIDGE RD TRANSPORT FIBER
	NOTES: BORE HOLE TO BE FILLED SAME DAY VAULT HOLE TO BE FILLED SAME DAY ALL HOLE TO BE TAMPED AND SOCCED		NO SCALE SHEET 8 OF 10			

NO MATCH SHEET

PROPOSED COMCAST UNDERGROUND
DIRECTIONAL BORE
4' MINIMUM DEPTH AT ALL POINTS
1 24CT FIBER CABLE
NO OTHER BURIED UTILITIES EXIST

INSTALLATION LENGTH IN RW ON THIS SHEET 925 FT

NO MATCH SHEET

MATCH SHEET 10

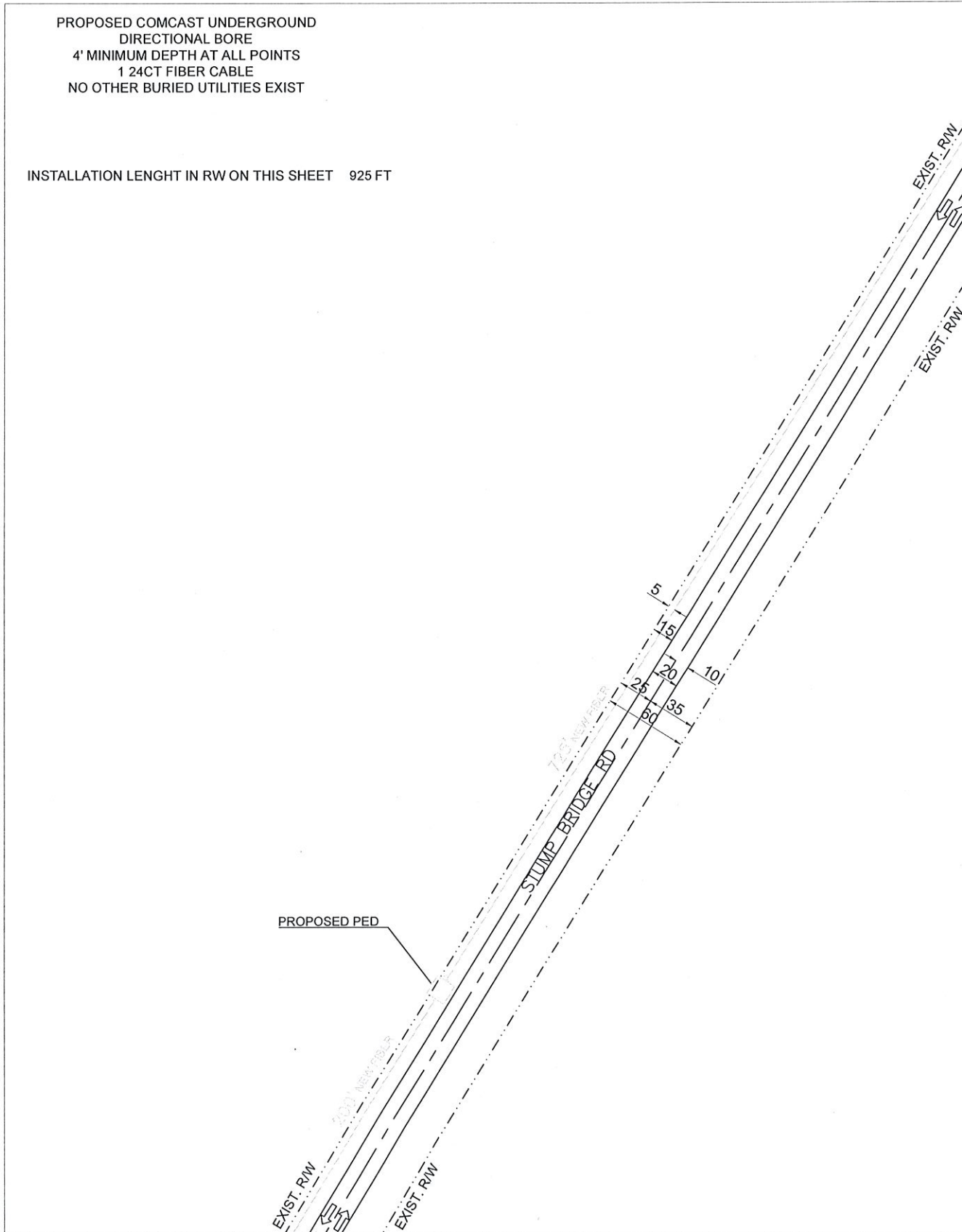

MATCH SHEET 8

PREPARED BY: 	EXISTING POLE PROPOSED PEDESTAL PROPOSED VAULT WATER VALVE FIBER MARKER GAS MARKER MANHOLE SEWER MANHOLE STORM DRAIN	RIGHT OF WAY LINE IRRIGATION LINE WATER LANE GAS LANE PROPOSED ANCHOR PROPOSED RISER LEGEND: RW - RIGHT OF WAY EOP - EDGE OF PAVEMENT DW - DRIVEWAY PDW - PAVED DRIVEWAY	PROPOSED COAXIAL CABLE PROPOSED FIBER CABLE PROPOSED DIRECTIONAL BORE EXISTING CABLE	 N B 8	ENGINEERED FOR: 	MADISON COUNTY STUMP BRIDGE RD TRANSPORT FIBER
	NOTES: BORE HOLE TO BE FILLED SAME DAY VAULT HOLE TO BE FILLED SAME DAY ALL HOLE TO BE TAMPED AND SOODED	NO SCALE SHEET 9 OF 10				

NO MATCH SHEET

PROPOSED COMCAST UNDERGROUND
 DIRECTIONAL BORE
 4' MINIMUM DEPTH AT ALL POINTS
 1 24CT FIBER CABLE
 NO OTHER BURIED UTILITIES EXIST

INSTALLATION LENGTH IN RW ON THIS SHEET 310 FT
 TOTAL INSTALLATION LENGTH 8067 FT
 AERIAL: 763 FT
 UG: 7304 FT
 START 32.68463, -89.97134
 END 32.69953, -89.95444

MATCH SHEET 9

NO MATCH SHEET

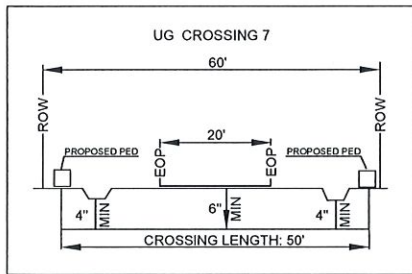
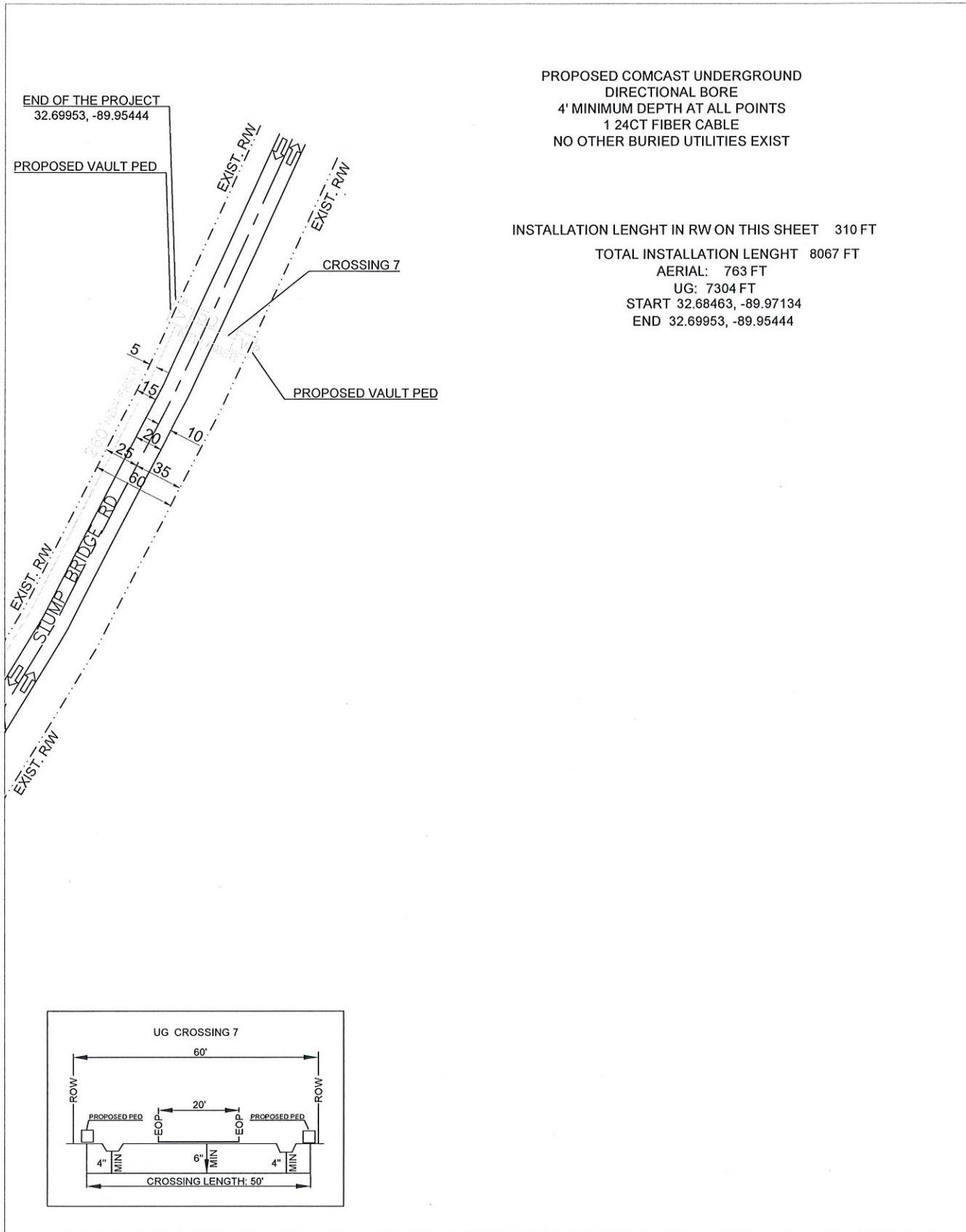

NO MATCH SHEET

PREPARED BY: 	EXISTING POLE PROPOSED PEDESTAL PROPOSED VAULT WATER VALVE FIBER MARKER GAS MARKER MANHOLE SEWER MANHOLE STORM DRAIN	RIGHT OF WAY LINE IRRIGATION LINE WATER LANE GAS LANE PROPOSED ANCHOR PROPOSED RISER	PROPOSED COAXIAL CABLE PROPOSED FIBER CABLE PROPOSED DIRECTIONAL BORE EXISTING CABLE		ENGINEERED FOR: 	MADISON COUNTY STUMP BRIDGE RD TRANSPORT FIBER
	LEGEND: RW - RIGHT OF WAY EOP - EDGE OF PAVEMENT DW - DRIVEWAY POW - PAVED DRIVEWAY	NOTES: BORE HOLE TO BE FILLED SAME DAY VAULT HOLE TO BE FILLED SAME DAY ALL HOLE TO BE TAMPED AND SOCCDED	NO SCALE SHEET 10 OF 10			